



Lara Menzel

Facades

Design
Construction
Technology

BRAUN



Address: 8803 Rüschlikon, Switzerland. Client: private. Completion: 2010. Building type: living. Other creatives: Scherrer Metec AG Zurich (façade systems).



↑ | View from lake



↑ | View towards lake
↓ | Detail drawing façade



↑ | Detail copper sheets
↓ | Detail west façade

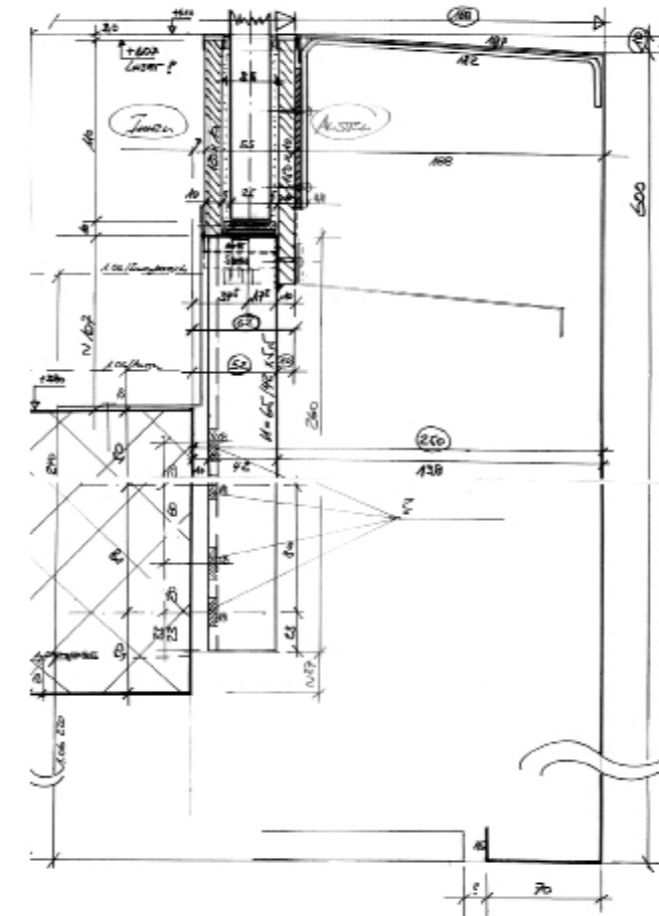

Duplex House

Rüschlikon

The two-party house near lake Zurich has a lively silver-grey shiny surface. The two cubic interlinked residential units appear completely separated. From the separate entrances to the outdoor areas that are integrated on different sides, the neighbors never notice each other and only share the underground garage. The three-dimensional intertwining provides both units with a view of the lake, sun, and private outdoor areas on the very terraced plot. The façade is completely clad in hand-tinned copper sheets, each with its individual grain and its own shine. The building opens up towards the lake by large-scale aluminum-framed glazing.

CONSTRUCTION FACTS

Structure: new building. **Construction type:** solid construction with rear ventilated curtain wall. **Material:** tin-coated copper plates. **Fixing:** punctuated fixing. **Insulation:** Minergie-standard.